

THROTTLE AND SPARK ADVANCE LINKAGE

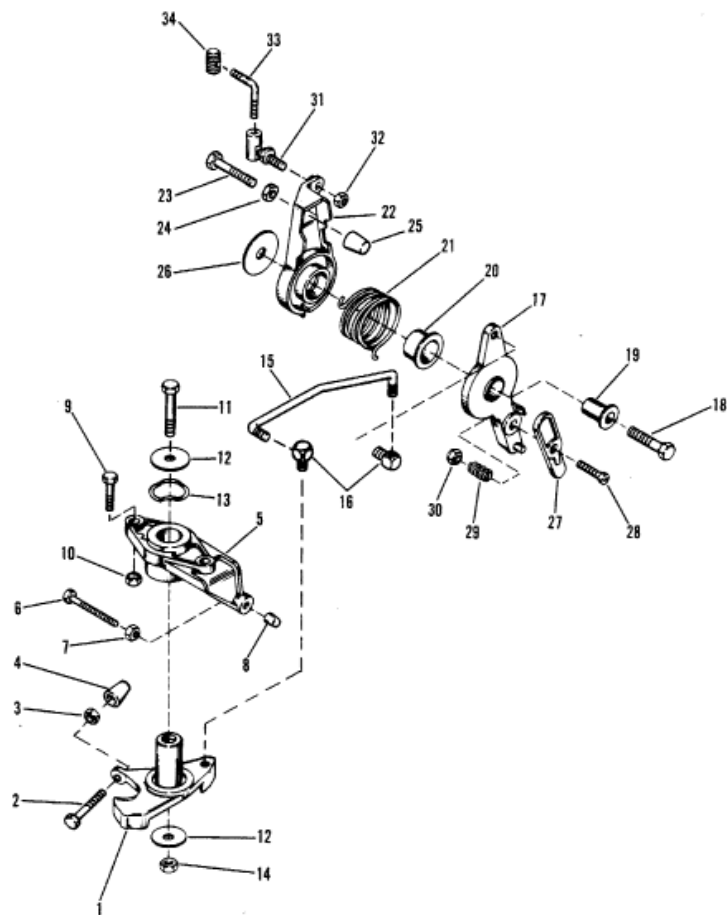

THROTTLE AND SPARK ADVANCE LINKAGE

| Parts List | | | | | |
|------------|-------|-------|-----------------------------------|-----|---|
| Ref | Class | Part | Description | Qty | Footnote |
| 1 | | 44405 | THROTTLE CAM, ACTUATOR | 1 | |
| 2 | 10 | 63102 | SCREW, ADJUSTING - THROTTLE | 1 | |
| 3 | 11 | 64015 | NUT, JAM - ADJUSTING SCREW | 1 | |
| 4 | | 26852 | CAP, NYLON - ADJUSTING SCREW | 1 | |
| 5 | | 39522 | BRACKET, THROTTLE CONTROL | 1 | |
| 6 | 10 | 64021 | SCREW, ADJUSTING - THROTTLE | 1 | |
| 7 | 11 | 64014 | NUT, JAM - ADJUSTING SCREW | 1 | |
| 8 | | 26852 | CAP, NYLON - ADJUSTING SCREW | 1 | |
| 9 | 10 | 20639 | SCREW, THROTTLE CONTROL | 2 | |
| 10 | 11 | 29250 | NUT, THROTTLE CONTROL BRACKET | 2 | |
| 11 | 10 | 69047 | SCREW | 1 | THROTTLE CONTROL BRACKET |
| 12 | 12 | 25893 | WASHER | 2 | THROTTLE CONTROL BRACKET |
| 13 | 13 | 62172 | WAVE WASHER | 1 | THROTTLE BRACKET/THROTTLE CONTROL BRACKET |
| 14 | 11 | 29250 | NUT | 1 | THROTTLE CONTROL BRACKET |
| 15 | | 95044 | LINK ROD | 1 | |
| 16 | | 95045 | SWIVEL, LINK ROD | 2 | |
| 17 | | 95049 | LEVER, THROTTLE CONTROL | 1 | |
| 18 | 10 | 55337 | SCREW | 1 | THROTTLE CONTROL LEVER |
| 19 | 23 | 55164 | BUSHING, THROTTLE CONTROL | 1 | |
| 20 | 23 | 55171 | BUSHING, THROTTLE CONTROL | 1 | |
| 21 | 24 | 55162 | SPRING, RETURN - SPARK ADVANCE | 1 | |
| 22 | | 95051 | LEVER, SPARK ADVANCE | 1 | |
| 23 | 10 | 32627 | SCREW, ADJUSTING - ADVANCE | 1 | |
| 24 | 11 | 68219 | NUT, JAM - ADJUSTING SCREW | 1 | |
| 25 | | 48039 | CAP, NYLON - ADJUSTING SCREW | 1 | |
| 26 | 12 | 68410 | WASHER, THROTTLE CONTROL | 1 | |
| 27 | | 39483 | LATCH, THROTTLE CONTROL | 1 | (THROTTLE CABLE) |
| 28 | 10 | 22486 | SCREW | 1 | LATCH TO THROTTLE CONTROL |
| 29 | 24 | 20099 | SPRING, COMPRESSION - LATCH | 1 | |
| 30 | 11 | 20586 | NUT, LATCH SCREW | 1 | |
| 31 | | 62459 | BALL JOINT, SPARK ADVANCE LINKAGE | 1 | |
| 32 | 11 | 46438 | NUT, BALL JOINT TO SPARK ADVANCE | 1 | |
| 33 | | 61940 | LINK ROD | 1 | |
| 34 | | 74897 | PIVOT, THREADED - TRIGGER P | 1 | |